



The Department recommends that you contact the Department of Conservation Office closest to where the activity is proposed to discuss the application prior to completing the application forms. Please provide all information requested in as much detail as possible. Applicants will be advised if further information is required before this application can be processed by the Department.

This form is to be used when the proposed activity is the building or use of any private or commercial facility or structure on public conservation land managed by the Department of Conservation. Examples may include lease of land to erect an information centre; authorisation to erect a weather station; or construct or lease a private/commercial campground or lodge. This form is to be completed in conjunction with either Applicant Information Form 1a (longer term concession) or Applicant Information Form 1b (one-off concession) as appropriate.

Please complete this application form, attach Form 1a or Form 1b, and any other applicable forms and information and send to permissions@doc.govt.nz. The Department will process the application and issue a concession if it is satisfied that the application meets all the requirements for granting a concession under the Conservation Act 1987.

If you require extra space for answering please attach and label according to the relevant section.

* The disused tennis court / concrete area will not be reinstated as a tennis court. Instead it will continue to be used as a boat trailer parking area for Hotel guests and members of the public utilizing the adjacent Portage Bay Boat Camp.

A. Description of Activity

Please describe the proposed activity in detail – where the site is located, please use NZTM GPS coordinates where possible, what you intend to use the building for, whether you intend to make any changes to the infrastructure.

Please include the name and status of the public conservation land, the size of the area for which you are applying and why this area has been chosen.

If necessary, attach further information including a map, a detailed site plan and drawings of proposal and label Attachment 3b:A. See attachment 3b:A

1. Hotel Accommodation (Pu 201)
2. Hotel Reception (Pu 202)
3. Swimming pool
4. Culvert + concrete bridge
5. Rock walls
6. Concrete area, lean-to, steps, outdoor shelter area with fireplace
7. Septic tank.

* See above N.B All structures are existing, and no further work is proposed.

B. Alternative sites considered

If your application is to build, extend or add to any permanent or temporary structures or facilities on public conservation land, please provide the following details:

- Could this structure or facility be reasonably located outside public conservation land? Provide details of other sites/areas considered.
- Could any potential adverse effects be significantly less (and/or different) in another conservation area or another part of the conservation area to which the application relates? Give details/reasons

N.A.

C. Larger area

Is the size of the area you are applying for larger than the structure/facility

YES / **(NO)**

If yes, please detail the size difference in the box below, and answer the following 3 questions, if no please go on to the next section:

Is this necessary for safety or security purposes?

YES / NO

Is this necessary as an integral part of the activity?

YES / NO

Is this essential to carrying on the activity?

YES / NO

If the answer to any of the above is yes, please provide details and attach supporting evidence if necessary and label Attachment 3b:C.

D. Exclusive possession

Do you believe you need **exclusive possession** of the public conservation land on which your structure/building is located, ie no one else can use the land during your use of it?

YES / NO

(Exclusive occupation requires a lease which requires public notification of the application)

If **yes**, please answer the following 3 questions, if no please go to the next section:

Is exclusive possession necessary to protect public safety?

YES / NO

Is exclusive possession necessary to protect physical security of the activity?

YES / NO

Is exclusive possession necessary for the competent operation of the activity?

YES / NO

If the answer to any of the above is yes, please provide details and attach supporting evidence if necessary and label Attachment 3b:D.

Yes for 1. Hotel Accommodation and 7. Septic tank, as they are private facilities requiring exclusive interest.

E. Technical Specifications (for telecommunications sites only)

Frequencies on which the equipment is to operate

Power to be used (transmitter output)

Polarisation of the signal

Type of antennae

The likely portion of a 24 hour period that transmitting will occur

Heaviest period of use

F. Term

Please detail the length of the term sought (i.e. number of years or months) and why.

Note: An application for a concession for a period over 10 years must be publicly notified, an application for a concession up to 10 years will not be publicly notified unless the adverse effects of the activity are such that it is required, or if an exclusive interest in the land is required.

30 years. All structures are related to the operation of The Portage Hotel.

G. Bulk fuel storage

Under the Hazardous Substances and New Organisms Act 1996 (HSNO Act) 'Bulk fuel storage' is considered to be any single container, stationary or mobile, used or unused, that has a capacity in excess of 250 litres of Class 3 fuel types. This includes petrol, diesel, aviation gasoline, kerosene and Jet A1. For more information on Hazardous Substances, go to:

<http://www.business.govt.nz/worksafe/information-guidance/legal-framework/hsno-act-1996>

Do you intend to store fuel in bulk on the land as part of the activity?

YES (NO)

If you have answered yes, then please provide full details of how and where you intend to store the fuel, and label any attachments including plans, maps and/or photographs as Attachment 3b:G. If your concession application is approved you will be required to provide a copy of your HSNO compliance certification to the Department before you begin the activity.

H. Environmental Impact Assessment

This section is one of the most important factors that will determine the Department's decision on the application. Please answer in detail.

In column 1 please list all the locations of your proposal, please use NZTM GPS coordinates where possible. In column 2 list any special features of the environment or the recreation values of that area. Then in column 3 list any effects (positive or adverse) that your activity may have on the values or features in column 2. In column 4 list the ways you intend to mitigate, remedy or avoid any adverse effects noted in column 3. Please add extra information or supporting evidence as necessary and label Attachment 3b:H.

Refer to Steps 1 and 2 in your Guide to Environmental Impact Assessment to help you fill in this section.

Location on public conservation land	Special feature or value	Potential effects of your activity on the feature or value (positive or adverse)	Methods to remedy, mitigate or avoid any adverse effects identified
EG: Tararua Forest Park	Northern rata - threatened species	Damage to the plants by construction	Brief construction and maintenance staff of the location and importance of the species; clearly tape off areas with the species to avoid damage
Portage bay	Portage bay	Septic tank malfunction	Regular maintenance / on-site maintenance manager.

I. Other

Is there any further information you wish to supply in support of your application? Please attach if necessary and label Attachment 3a:1.

No.

Identifier

885567

Land Covenant in Easement Instrument 8024899.1 - 9.9.2009 at 3:50 pm (affects part formerly Unit GAG and Unit GAH on DP 8394)
 1 1205417.3 Notice of change of body corporate operational rules pursuant to Section 106 Unit Titles Act 2010 - 5.10.2018 at 4:37 pm
 1 1486292.34 Certificate of reassessment of ownership interest pursuant to Section 69(3) Unit Titles Act 2010 - 13.8.2019 at 4:42 pm

ATTACHMENT 20. A.

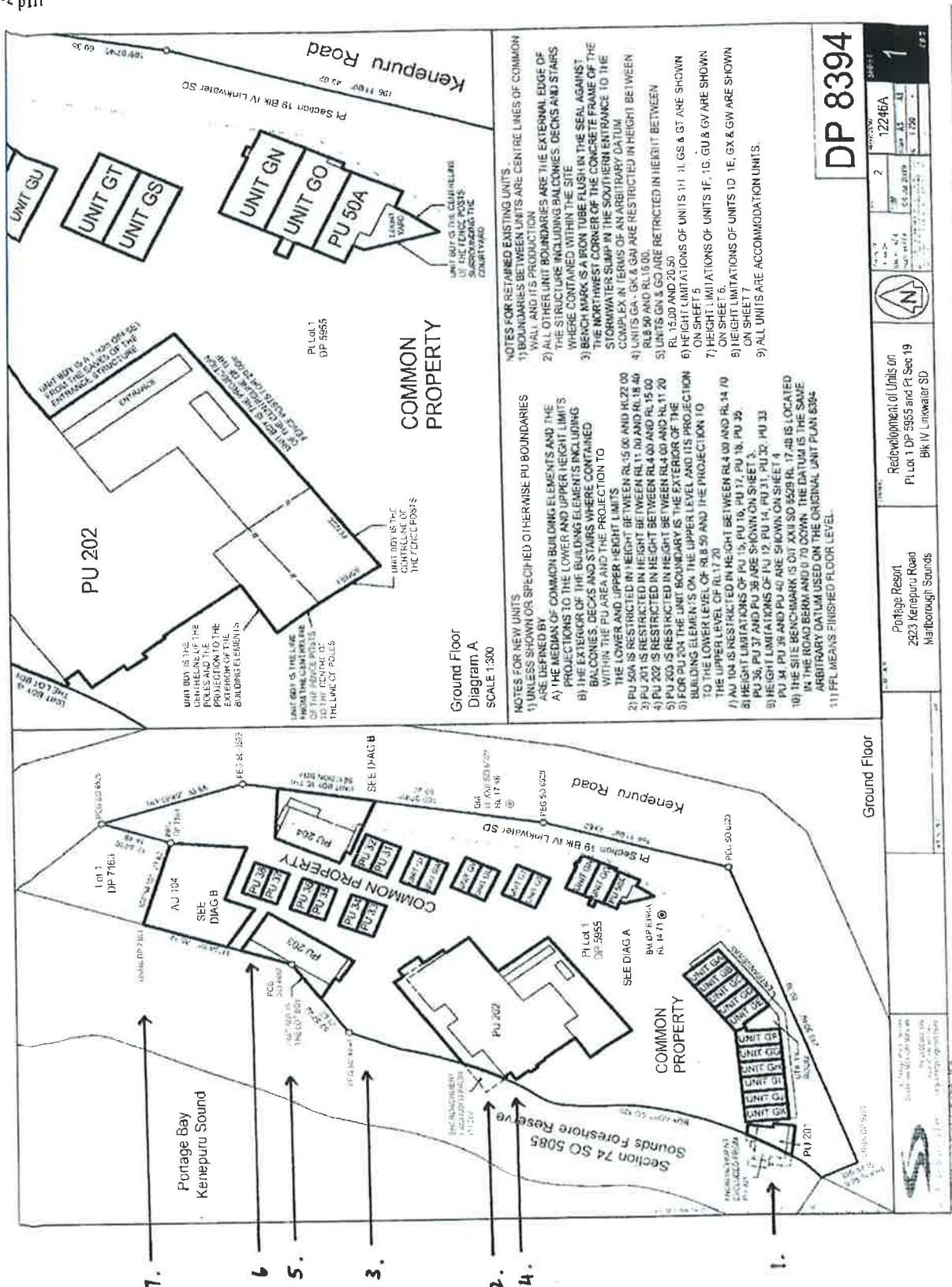

DP 8394

1	12246A	1
2	12246A	1
3	12246A	1
4	12246A	1
5	12246A	1
6	12246A	1
7	12246A	1
8	12246A	1
9	12246A	1
10	12246A	1
11	12246A	1
12	12246A	1
13	12246A	1
14	12246A	1
15	12246A	1
16	12246A	1
17	12246A	1
18	12246A	1
19	12246A	1
20	12246A	1
21	12246A	1
22	12246A	1
23	12246A	1
24	12246A	1
25	12246A	1
26	12246A	1
27	12246A	1
28	12246A	1
29	12246A	1
30	12246A	1
31	12246A	1
32	12246A	1
33	12246A	1
34	12246A	1
35	12246A	1
36	12246A	1
37	12246A	1
38	12246A	1
39	12246A	1
40	12246A	1
41	12246A	1
42	12246A	1
43	12246A	1
44	12246A	1
45	12246A	1
46	12246A	1
47	12246A	1
48	12246A	1
49	12246A	1
50	12246A	1
51	12246A	1
52	12246A	1
53	12246A	1
54	12246A	1
55	12246A	1
56	12246A	1
57	12246A	1
58	12246A	1
59	12246A	1
60	12246A	1
61	12246A	1
62	12246A	1
63	12246A	1
64	12246A	1
65	12246A	1
66	12246A	1
67	12246A	1
68	12246A	1
69	12246A	1
70	12246A	1
71	12246A	1
72	12246A	1
73	12246A	1
74	12246A	1
75	12246A	1
76	12246A	1
77	12246A	1
78	12246A	1
79	12246A	1
80	12246A	1
81	12246A	1
82	12246A	1
83	12246A	1
84	12246A	1
85	12246A	1
86	12246A	1
87	12246A	1
88	12246A	1
89	12246A	1
90	12246A	1
91	12246A	1
92	12246A	1
93	12246A	1
94	12246A	1
95	12246A	1
96	12246A	1
97	12246A	1
98	12246A	1
99	12246A	1
100	12246A	1